

# LRM001

LoRa® Mini PCIe, 433/868/915MHz

Range : 7Km

## Features

- . Mini PCI Express form factor
- . 2 u.FL antennas to support 433 or 868 or 915MHz
- . Range 7KM
- . FTD® 232HL

## Specification

- . Compliant with LoRa®
- . Mini PCI Express form factor
- . 2 u.FL antennas to support 433 or 868 or 915MHz
- . Range 7KM
- . Data rate 1k bps
- . Network type: Star
- . Standby current: 0.1mA
- . Rx current: 12ma
- . Microchip® RN2483 LoRa®
- . FTD® 232HL
- . RF Output power (maximum) 20dbm
- . Receiver sensitivity: -130 dbm
- . Support Win 7 and Window 10
- . Support Linux : Ubuntu 12.04
- . Hardware LoRa® reset
- . Dimension: 50 x 29 x 9 mm

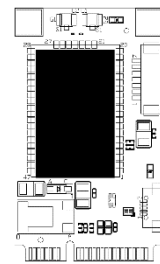
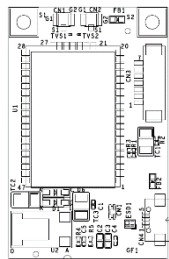
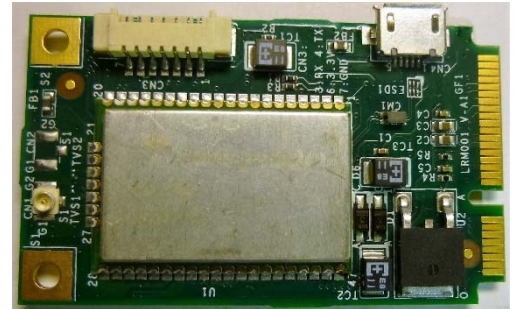

## Interface



LiYA Tech. Corp.  
Email :[info@liyatech.com](mailto:info@liyatech.com)

\*All specifications are subject to change without notice.

	LRM001	LRM002	LRM003 (April)	LRM005 (May)
Mini PCIe Full Size	✓		✓	
USB 2.0	✓		✓	
UART		✓		
M.2				✓
433M or	✓ Model 433	✓ Model 433	✓ Model L	✓ Model L
868M or	✓ Model 868	✓ Model 868	✓ Model H	✓ Model H
915M or	✓ Model 915	✓ Model 915	✓ Model H	✓ Model H

### Model Lists:

LRM001-433	<i>Mini PCIe USB 433MHz</i>
LRM001-868	<i>Mini PCIe USB 868MHz</i>
LRM001-915	Mini PCIe USB 915MHz
LRM002-433	UART 433MHz
LRM002-868	UART 868MHz
LRM002-915	UART 915MHz
LRM003-L	Mini PCIe USB 410 ~525MHz
LRM003-H	Mini PCIe USB 862 ~1020MHz

### Common Specification:

Operating Humidity	5% ~ 95% RH
Operating Temperature	-20° C~ 60 °C
Storage Temperature	-20° C~ 80 °C

### Packing List

u. FL Antenna Cable  
433 or 868 or 915MHz Antenna

