

LRM003

LoRa® Mini PCIe 862 ~ 1020MHz

Range : 7Km

Features

- . Mini PCI Express form factor
- . u.FL antennas to support 862 ~ 1020MHz
- . Range 7KM

Specification

- . Compliant with LoRa®
- . Mini PCI Express form factor
- . u.FL antennas to support 862 ~ 1020MHz
- . Range 7KM
- . Data rate 1k bps
- . Network type: Star
- . Standby current: 0.1mA
- . Rx current: 12ma
- . Globalsat® LM-130E® LM-130H®
- . FTD® 232HL
- . RF Output power (maximum) 20dbm
- . Receiver sensitivity: -130 dbm
- . Support Win 7 and Window 10
- . Support Linux : Ubuntu 12.04
- . Dimension: 50 x 29 x 9 mm

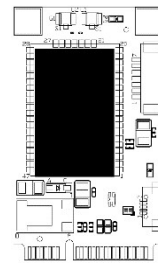
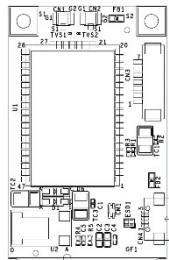

Interface



LiYA Tech. Corp.
Email :info@liyatech.com

*All specifications are subject to change without notice.

	LRM003	LRM005 (September)
Mini PCIe Full Size	✓	
USB 2.0	✓	
UART		
M.2		✓
433M or	✓ Model E	✓ Model L
868M or	✓ Model H	✓ Model H
915M or	✓ Model H	✓ Model H

Model Lists:

LRM003-E	Mini PCIe USB 915MHz
LRM003-H	Mini PCIe USB 868MHz

Common Specification:

Operating Humidity	5% ~ 95% RH
Operating Temperature	-20° C~ 60° C
Storage Temperature	-20° C~ 80° C

Packing List

u. FL Antenna Cable
868 or 915MHz Antenna



LiYA Tech. Corp.
Email :info@liyatech.com

*All specifications are subject to change without notice.